

Submittal

Centralized Controller CE50-24/E

- This smart zone controller is intended for VRF, U-match (Optional for U-Match Duct, Cassette and Floor Ceiling) Free match (Optional for Free Match Duct, Cassette, Floor Ceiling and Wall Mounted) series.

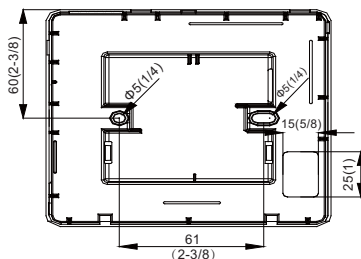
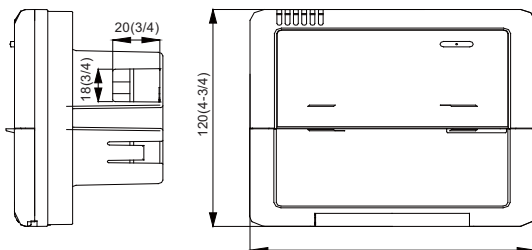
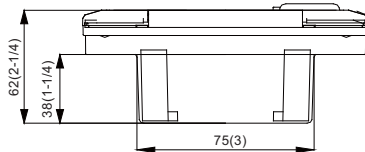

Unit:mm(inch)

Function Introduction

Capable of controlling up to 3 sets of multi VRF units and multi sets of U-match and Free match units with maximum 16 indoor units.

Through this smart zone controller, it is available to view and control those running parameters of the indoor unit, including on/off, running mode, fan speed etc, and also perform the single control and centralized control, further, it also can set the weekly timer and long-distance shielding to realize convenient control to the air conditioning system.

- Single control: it is intended to control the running parameters of a designated indoor unit individually.
- Centralized control: it is intended to control the running parameters of all indoor units at the same time.
- Shielding under single or centralized control: it is intended to shield the running parameter of the indoor unit.
- Weekly timer under single or centralized control: it is intended to set when to start/stop the unit through long-distance control.
- Clock: it is intended to set and display the weekday, hour and minute.

After the debugging to the controller is finished, it can check the on-line indoor units and display the parameter setting of the current running mode, set temperature, fan speed, weekly timer, shielding function etc. When some error occurs, the error symbol and the error code will be displayed to warn a quick maintenance.

This smart zone controller can be connected to the unit through the communication line without the need of the communication module, which can extremely ease and simplify the installation.

This smart zone controller can be integrated with the long-distance monitoring system and the centralized controller (it indicates the controller that should be equipped with the communication module) and the control of the long-distance monitoring system and the centralized controller takes priority over that of the smart zone controller.

Name	Description
Fan speed	It displays the fan speed of the indoor unit, high, medium, low and auto.
Running mode	It displays the running mode of the indoor unit, auto, cool, dry, fan and heat.
System clock	It displays the current time (hour and minute) in 24-hour time system and also the week day.
Shield	It displays the shielded status, "ALL", "TEMP", "MODE" and "ON/OFF".
Weekly timer	It displays the timing period (unit: 0.5 hour) which will circulate every week.
Set temperature Indoor unit code	It displays the set temperature, indoor unit code (01-16), and symbols of Celsius and Fahrenheit scale.
Control mode	It displays "CENTER" under the centralized control mode and no display under the single control mode.
Ambient temperature Serial port	It displays the ambient temperature, serial port as well as symbols of Celsius and Fahrenheit scale.
Indoor unit code On/off status	Numbers indicate the indoor unit codes which will be displayed when the corresponding indoor unit is online; "□" indicates the on/off status of the indoor unit, that is, when it is bright, it means the unit is "On"; when it is gone out, it means the unit is "Off".
Error Child lock	It displays the error codes when some error(s) arises and also "CHILD LOCK" when this function is activated.

Job Name:

Schedule Reference:

Date: